

# INDUSTRIAL METAL STORAGE CABINETS



# Series 248 - 48" Wide Double Door Cabinet



Series 248

**“Did you know you can order these with CLEAR Plexiglass doors?”**

***“After one look I can see why this is one of the best steel cabinets on the market... I just love the door caddies!”***

- Galvanized steel construction provides strength, durability and corrosion resistance.
- Our engineered frames have a double offset for superior strength.
- 375lb. weight per shelf.
- Four fixed full size shelves and one 10" half shelf.
- Three 3" heavy duty hinges per door.
- Riveted stiffener channels on all doors.
- Center supports on all shelves.
- Spray can caddy and small part tray are standard on both doors.
- Slam latches with locks are standard on all cabinets.

Model	Depth	Length	Height	Weight	Material / Finish
Series 248	22"	48"	80"	352#	18ga. / Galv.

# Series 268 - Double Door Cabinet



Series 268

- We offer limited color options.
- Our new open bottom frame allows for forklift or pallet jack lifting.
- 300lb. weight per shelf.
- Adjustable 8" wide inside shelf for smaller parts.

**Our best seller!**



Series 268

- Three 3" heavy duty hinges per door.
- Riveted stiffener channels on all doors.
- Center supports on all shelves.
- Spray can caddy and small part tray are standard on both doors.
- Slam latches with locks are standard on all cabinets.

Model	Depth	Length	Height	Weight	Material / Finish
Series 268	22.5"	60"	80"	375#	18ga. / Galv.



# Series 258 - Storage and Supply Cabinet



Series 258



## **TESTIMONIAL**

*"I have two of these in my repair shop... I love the new door design!"*



Series 258

- Comes with two 100lb. drawers with compartments built into center shelf.
- Our engineered corner frames have a double offset for superior strength.
- Includes a 6" wide x 54" pegboard mounted on the back wall.
- All shelves are rated for 250lbs. each.
- All new door design with extra stiffener channels all around.
- Spray can caddies and small parts trays on each door.

Model	Depth	Length	Height	Weight	Material / Finish
Series 258	20.5"	54.5"	80"	265#	20ga. / Galv.

# Series 138 & 238 - Single Door Cabinets



**Series 138**

- Galvanized steel construction provides strength, durability and corrosion resistance.
- Our engineered corner frames have a double offset for superior strength and shelves are spaced for larger areas on the bottom of cabinet.
- Riveted box channels on all doors for extra strength plus spray can holders and small part trays on all doors.
- We use channel stiffeners on all shelves.
- Slam latches with locks are standard on all cabinets.



**Series 238**

**“The 138  
is perfect for all  
your extra parts  
and fittings.”**

Model	Depth	Length	Height	Weight	Material / Finish
Series 238	22"	36"	80"	250#	18ga. / Galv.
Series 138	18"	32"	80"	228#	20ga. / Galv.



# Series WC36 - Welding Supply Cabinet



Series WC36

- Galvanized steel construction.
- Designed for organizing and storing welding supplies.
- 15 shelf bins compartments offers lots of options for organizing items.
- Single drawer with 18 metal compartments for small parts.
- Full width shelf on top and two on bottom are design to support 300lbs.
- Slam latches with locks are standard on all cabinets.
- Can caddy and parts tray on each door.

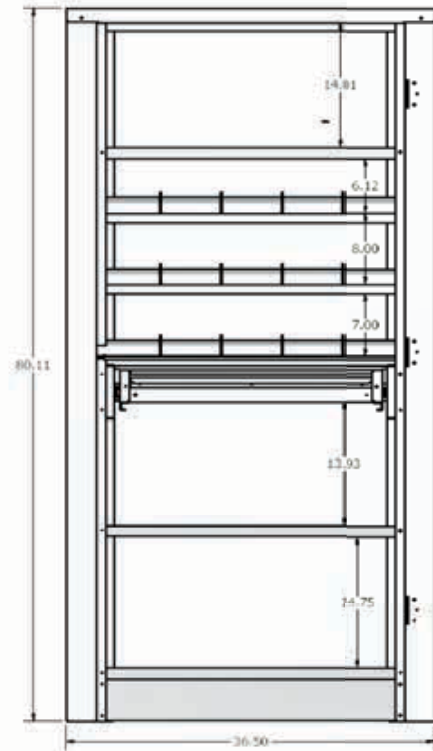

## TESTIMONIAL

*"Great supply cabinet I don't know how I got by without one. I love the small part drawer for all my welding consumables."*

Model	Depth	Length	Height	Weight	Material / Finish
Series WC36	21.5"	36.5"	80"	280#	18-20ga. / Galv.

# Space Saving Wall Mounted Cabinets - For Any Area!



**Series 143**



**Series 134**



**WC24**



**Series 163**



**Series 113**

- 20 gauge galvanized steel construction.
- We offer 4 sizes in our wall mount cabinets.
- Slam latches with locks are standard on all wall mount cabinets.

Model	Depth	Length	Height	Weight	Material / Finish
Series 134	18"	36"	40"	92#	20ga. / Galv.
Series 143	14"	48"	36"	106#	20ga. / Galv.
Series 163	14"	60"	36"	125#	20ga. / Galv.
Series WC24	12"	24"	36"	50#	20ga. / Galv.
Series 113	7.75"	14"	32"	25#	20ga. / Galv.

# Series MWB28 - Modular Work Bench Cabinets



**MWB28-SD**



**MWB28-4D**

- Galvanized steel construction with the option to powder-coat any color.
- Our premium quality modular work benches are available in different styles and sizes allowing you to choose the option that best fits your needs.
- See page 17 for worktop options 

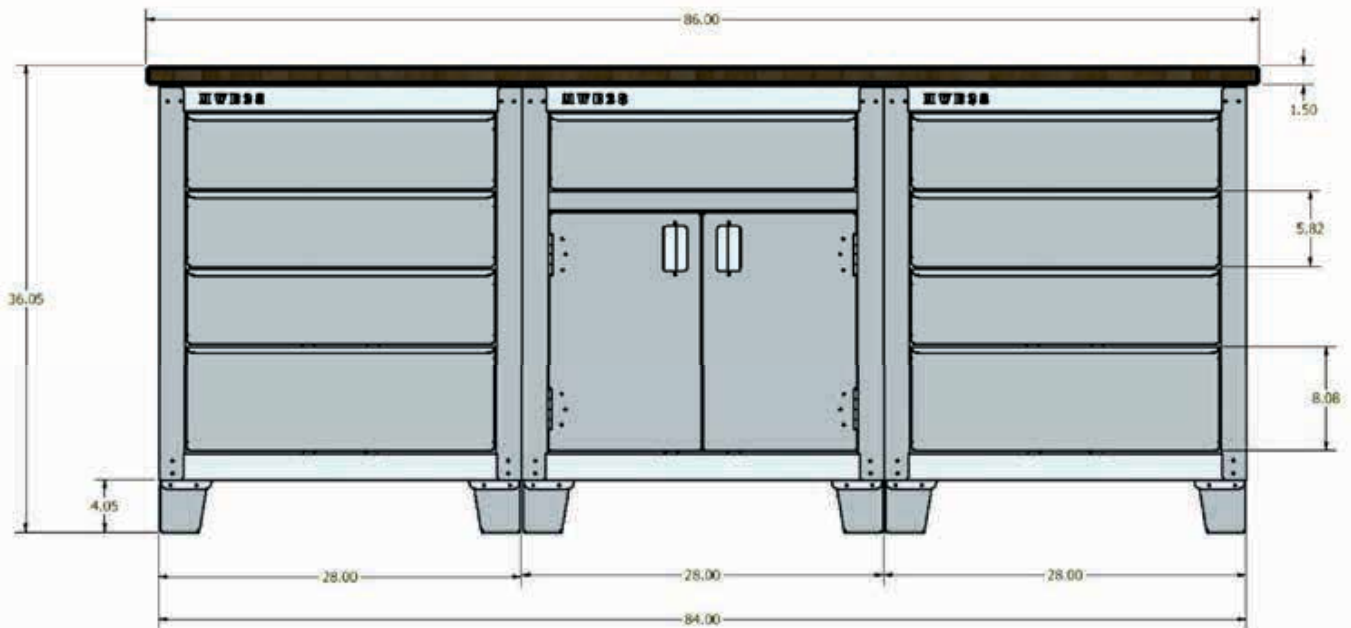

Model	Depth	Length	Height	Weight	Material / Finish
Series MWB28-4D	28"	28"	34.5"	245#	18ga. / Galv.
Series MWB28-SD	28"	28"	34.5"	210#	18ga. / Galv.



# Modular Work Bench Top Options

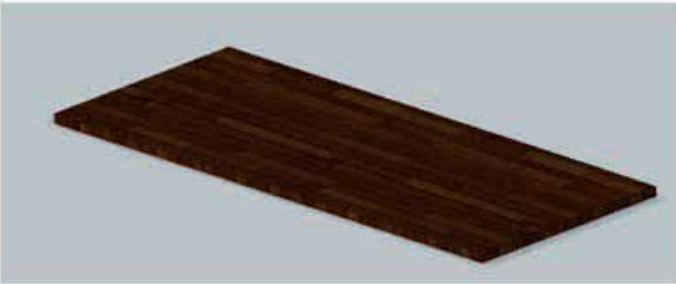
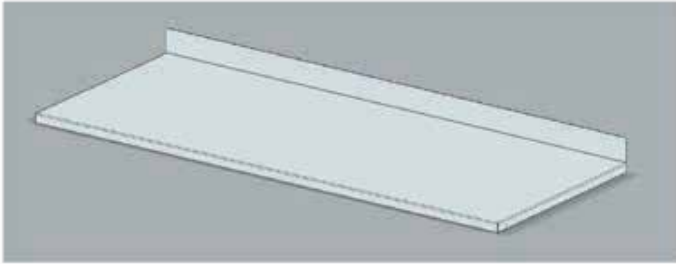

- Call us to get pricing for your standard 30" wide work tops
- 304 stainless steel is available in 12 gauge or 14 gauge
- Our mild steel work tops come in 11 gauge
- Our wood tops are 1/5" thick and 30" wide made with maple hard wood

*\*Galvanized finish is standard.  
Additional color option shown below.*

**Wood Top**



**Stainless Steel Top**



- We offer 6 color options in power coated finishes
- Our premium quality modular work benches are available in 2 styles allowing you to build a work bench in 28" increments. 28", 56", 84", 112", 140", you choose the option that best fits your needs or budget.
- For the work tops we offer stainless steel or mild steel plus butcher block wood or you can build your own and save money

Model	Depth	Length	Height	Weight	Material / Finish
Series MWB28-4D	28"	28"	34.5"	245#	18ga. / Galv.
Series MWB28-SD	28"	28"	34.5"	210#	18ga. / Galv.

# Series 344 - Industrial Work Desk With Drawer



**Series 344**

## **KEY FEATURES:**

- 200lb. ball bearing slides.
- Lockable slam latch on bottom cabinet.
- Double off set corner frames and legs.
- Wood base top support for extra strength.
- 14 gauge heavy duty zinc hinges.



**Series 344**

- 18 gauge galvanized steel construction.
- 4" deep x 36" wide drawer for dust free storage.
- Large bottom storage area with doors.
- Works great for all your paperwork or paper filing and computer work station.
- 18 gauge stainless steel sloped tops are now standard.

Model	Depth	Length	Height	Weight	Material / Finish
Series 344	28"	40"	40"	180#	18ga. / Galv.

# Series DC3048 - Industrial Drawer Cabinet



**Series DC3048**

- 18 gauge galvanized construction for strength and durability.
- Six drawers 21" x 23" x 3.5" deep.
- Bottom drawer 21" x 23" x 7" deep.
- Adjustable metal compartment dividers.
- Works great for organizing all your small parts and fittings.
- Seven 400lb. capacity compartment drawers.
- Overall size: 27"D x 30"W x 48"H.
- Weight: 450lbs.

## **KEY FEATURES:**

- *Fulterer brand 400lb. ball bearing drawer slides.*
- *Full length formed drawer handles.*
- *Deep formed top and side support channels.*

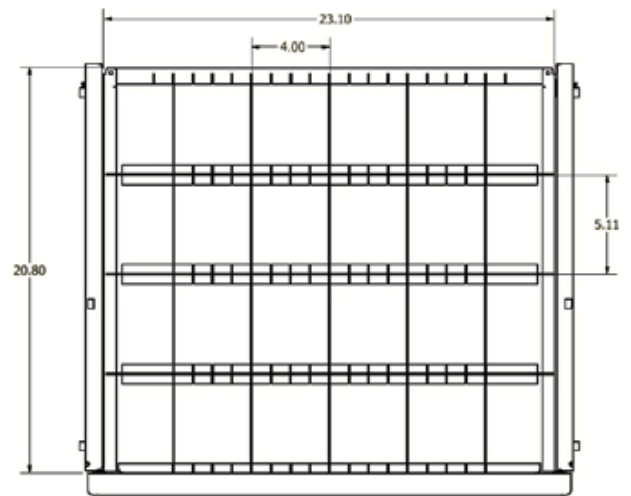

**Top View Drawer Layout**

Model	Depth	Length	Height	Weight	Material / Finish
Series DC3048	27"	30"	48"	450#	18ga. / Galv.

# Series CD14 - Modular Drawer Cabinet



Series CD14

## KEY FEATURES:

- 100# ball bearing slides
- Full length formed drawer handle
- Adjustable metal dividers
- 12 compartments - 3.25" x 3.5"
- 1 compartment - 3.25" x 14"

- 20 gauge galvanized construction for strength and durability
- Drawer size: 13.75" L x 14" W x 2.75" D
- Works great for organizing nuts, bolts & screws
- Three 75# capacity compartment drawers

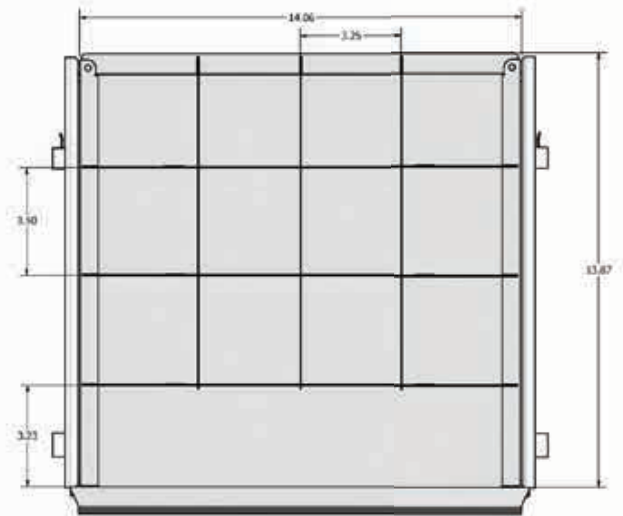

Series CD14



Series CD14

**I use them on all my work benches. It's really good for all my fasteners.**

Model	Depth	Length	Height	Weight	Material / Finish
Series CD14	15.5"	16.5"	10.5"	37.5#	20ga. / Galv.

# Series DM24 - Modular Drawer Cabinet



**Series DM24**

## **KEY FEATURES:**

- 100lb. ball bearing slides
- Full length formed drawer handles
- Adjustable metal compartment dividers
- 15 compartments 4" x 3.75"
- Two compartments - 3.75" x 20"

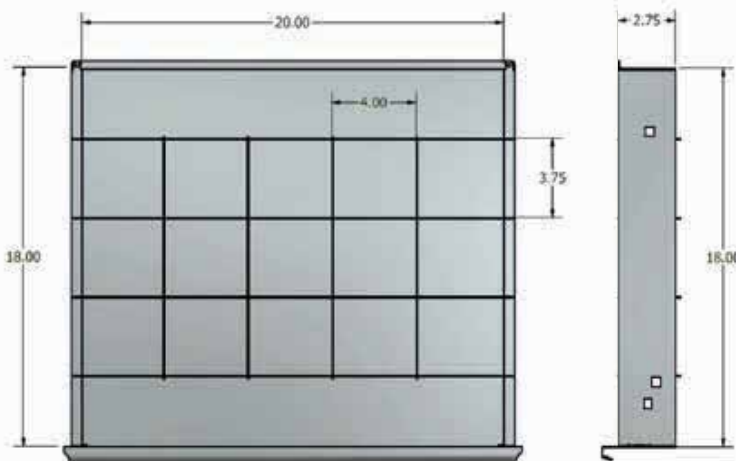

**Top and Side View of Drawer Layout**

**Great for  
fastener  
storage!**

- 20 gauge galvanized construction for strength and durability.
- Drawer size: 18" long x 20" wide x 2.75" deep.
- Designed to fit our Series 268 cabinet.
- Works great for organizing nuts, bolts and screws.
- Four 75lb. capacity compartment drawers.

Model	Depth	Length	Height	Weight	Material / Finish
Series DM24	19.5"	24"	17"	77#	20 ga. / Galv.

# Series BC36 - Bin Compartment Cabinet

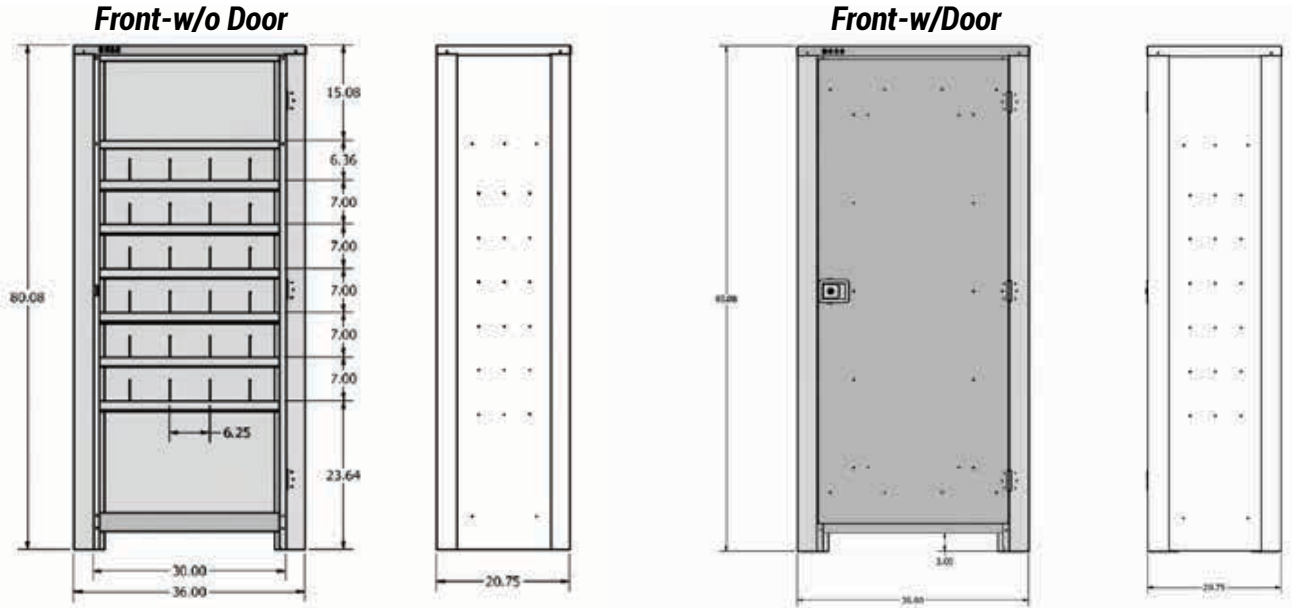

## New for 2024

Great for organizing smaller items or  
dividers can be removed for larger items.  
One top shelf and a large bottom  
area for larger items.

This design comes with 30 compartments  
6.25" wide x 7" tall and 15" deep

**Made with  
18 & 20 ga.  
F90 Galvanized  
Steel**

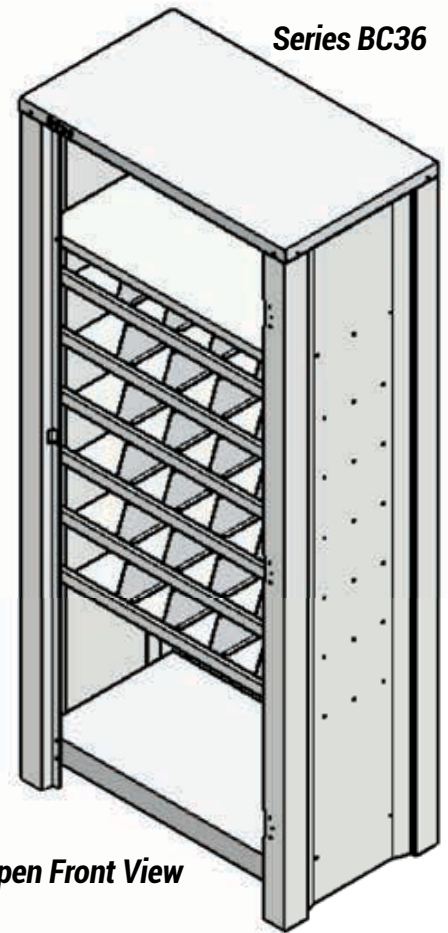

Open Front View

Model	Depth	Length	Height	Weight	Material / Finish
Series BC36	20.75"	36"	80"	220#	18 & 20ga. / Galv.

# Series WT634 - Welding Table

**If you need a welding table that is fast and easy to set up, this table is for you**

- 3/8" steel welding table - laser cut.
- Sold as a DIY weld table kit with all the parts interlocking for a precise fit.
- Designed with 5" tall supports spaced every 10" OC.
- Customer has the option to make the table legs to any height.
- Comes with four leg mount bases.
- Designed to work with strong hand clamps and accessories.



Model	Depth	Length	Height	Weight	Material / Finish
Series WT634	6"	46"	36"	385#	3/8" Steel

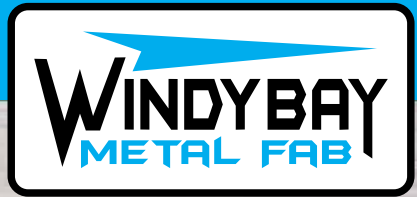

## **WB Metal Fab**

**NW 33-4-11W**

**Pilot Mound, MB**

**R0G 1P0 Canada**

**cell: (204) 245-0508**

***mike@wbmetalfab.com***

**204-825-2401**

***Our modular design allows you to design and setup your work area many different ways. We offer tables, work benches, wall cabinets, bin cabinets, freestanding single and double door cabinets to suit all your needs.***



***We offer custom designed cabinets!***

**[www.wbmetalfab.com](http://www.wbmetalfab.com)**